



## 190-32 120° Door Viewer Fitting Instructions

### Installing Door Viewer - 120° Plastic Lens

**Note:** Suitable for doors between 35mm and 54mm in thickness

To fit a Door Viewer you will require:

- Pencil
- Flat blade screwdriver
- Drill
- 12mm drill bit

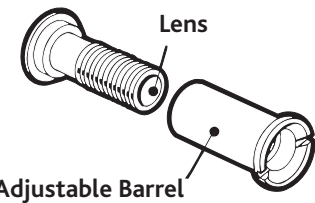

- Select position at eye level in the centre of the door. Mark position and drill a 12mm hole through the door
- Insert lens through the door from the outside
- Insert adjustment barrel from inside the door and while holding the lens, screw the adjustment barrel until tight. Use screwdriver if necessary

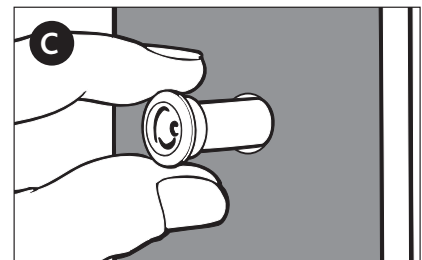
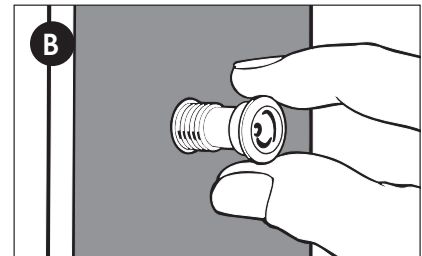
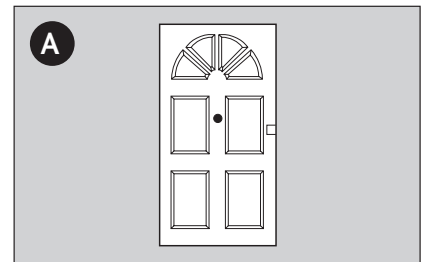

### Additional Information

#### Security Tips

We recommend you always view visitors through the door viewer before opening the door

For additional safety we recommend the use of an ERA 791 Door Chain or the ERA 700 Concealed Door Chain

#### Maintenance

Use a moist cloth only, household abrasives or solvents may affect the surface finish