

Balmoral Offset Handle Fitting Detail

- 1 Check that the door has the correct preparation for the handle set required. In this instance a Balmoral Offset Snib handle preparation has been used.

Note: This instruction assumes that cylinders would have been previously fitted prior to on-site installation of hardware

The choice of door lock installed depends whether or not actual lever pad functionality is possible

The pad style external handle is an aesthetic shape only and could also take the form of a lever

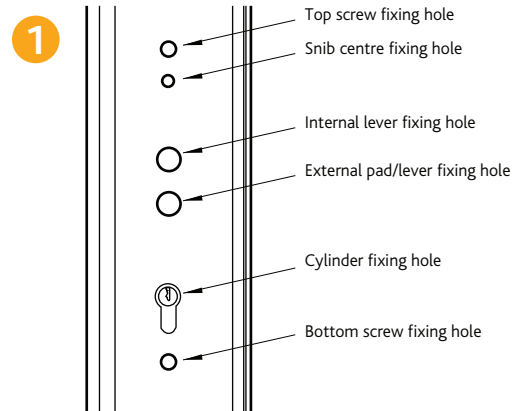

- 2 For correct lever pad operation the lever and snib handle should be on the internal of the door only

- a Place one of the spindles from the packaging into the internal lever as shown in image
- b Ensure the snib (if used) aligns correctly to the snib centre fixing hole
- c Ensure the lever is correctly handed and aligned pointing towards the hinge side of the door
- d Place the lever set against the door profile, aligning the spindle to the internal lever fixing hole
- e The existing cylinder or locking barrel should also align correctly to the lever set as shown in image
- f Insert the two fixing screws provided

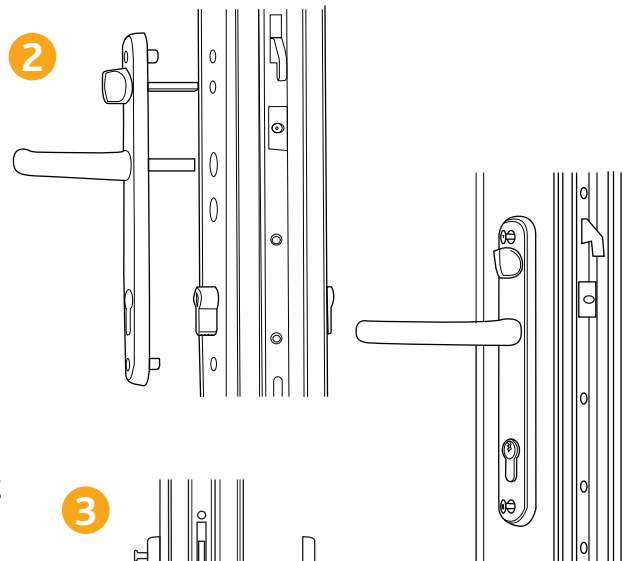

- 2 With the internal lever set aligned correctly proceed to fitting the external pad/lever offset handle set

- a Place one of the spindles from the packaging into the External pad/lever and align with external pad/lever fixing hole as shown in image
- b Ensure the pad or lever is correctly handed and aligned pointing toward the hinge side of the door
- c Offer the handle set up to the door profile and ensure correct alignment with the fixing holes and carefully place the lever set over the existing cylinder or locking barrel
- d The fixing screw supports on the underside of the handle set should match up with the screws placed into the internal lever set. Some adjustment and aligning may be required to perfectly match these two screws to the external handle depending on the accuracy of the door preparation
- e With both internal and external handle sets correctly aligned hold the two parts firmly together against the profile and use the correct screw driver hand tighten the fixing

