

316 Stainless Steel Round Bar Handles

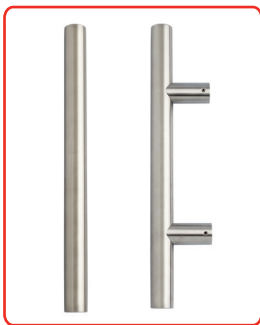

Offset Bar Handle



Inline Bar Handle



Bow Handle



D Handle



V Handle



Centre Knob

Features

- **Brushed stainless steel bar handles**
For a stunning entrance door with contemporary styling
- **Austenitic grade 316 stainless steel construction**
Ultimate corrosion resistance
- **Meticulously produced quality product**
For a high quality finish with precision corners and joints for a lasting finish
- **Inline, Offset, Bow, D and V style handles with a choice of fixings**
Available as single fix handle or back to back with fixings included for ease of ordering
- **Fixings to suit Timber, Composite, Aluminium and PVCu**
No cutting of screws for faster, more efficient installation. Fixings for PVCu available to order
- **A choice of screw packs available**
Provides a safe and secure fixing
- **Complementary brushed escutcheon to suit Euro Profile cylinders**
Compatible with all Euro Profile cylinders and key wind up locks

Available finishes:

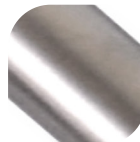

Stainless Steel

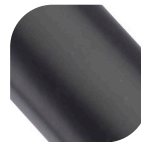

Matte Black



Oval Escutcheon



Square Escutcheon



Single fix

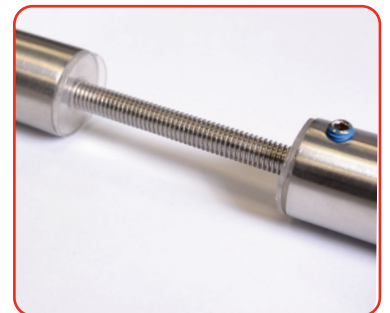

Back to back fix



10 YEAR
Mechanical
Guarantee



PVCu



Timber



Composite

316 Stainless Steel Round Bar Handles

Ordering Details

| Bar Type | No. of Fixings | Offset | Inline |
|--|----------------|-----------------|-----------------|
| Round Bar Handles - Stainless Steel | | | |
| 400mm | 2 | DHBHOF400-316* | DHBHIN400-316* |
| 600mm | 2 | DHBHOF600-316* | DHBHIN600-316* |
| 800mm | 2 | DHBHOF800-316* | DHBHIN800-316* |
| 1000mm | 2 | DHBHOF1000-316* | DHBHIN1000-316* |
| 1200mm | 2 | DHBHOF1200-316* | DHBHIN1200-316* |
| 1400mm | 3 | DHBHOF1400-316* | DHBHIN1400-316* |
| 1600mm | 3 | DHBHOF1600-316* | DHBHIN1600-316* |
| 1800mm | 3 | DHBHOF1800-316* | DHBHIN1800-316* |

*Fixing pack included. Add suffix to part number: **SI** for Single or **BB** for Back to Back e.g. DHBHOF400-316BB

Round Bar Handles - Matte Black

| | | | |
|--------|---|----------------|----------------|
| 400mm | 2 | DHBHOF400-MB* | DHBHIN400-MB* |
| 600mm | 2 | DHBHOF600-MB* | DHBHIN600-MB* |
| 800mm | 2 | DHBHOF800-MB* | DHBHIN800-MB* |
| 1000mm | 2 | DHBHOF1000-MB* | DHBHIN1000-MB* |
| 1200mm | 2 | DHBHOF1200-MB* | DHBHIN1200-MB* |
| 1400mm | 3 | DHBHOF1400-MB* | DHBHIN1400-MB* |
| 1600mm | 3 | DHBHOF1600-MB* | DHBHIN1600-MB* |
| 1800mm | 3 | DHBHOF1800-MB* | DHBHIN1800-MB* |

*Fixing pack included. Add suffix to part number: **SI** for Single or **BB** for Back to Back e.g. DHBHOF400-MBBB

Shaped Bar Handles - Stainless Steel

| Bar Type | No. of Fixings | Part No. |
|-------------------------|----------------|------------------|
| Bow Handle 600mm | 2 | DHBHBOW600-316** |
| Bow Handle 990mm | 2 | DHBHBOW990-316** |
| D Handle | 2 | DHBHD332-316SI |
| V Handle | 2 | DHBHV332-316SI |

Fixing pack included. Add suffix to part number: **SI for Single, **BB** for Back to Back or **SN** for Single Non Grub Screw fixing e.g. DHBHBOW600-316SN.

For Matte Black part numbers, please contact our customer services department.

Accessories - Stainless Steel

| | |
|-------------------|--------------|
| Centre Knob | DFKBSS75-316 |
| Oval Escutcheon | BHESC-OVAL |
| Square Escutcheon | BHESC-SQUARE |

Accessories - Matte Black

| | |
|-------------------|-----------------|
| Oval Escutcheon | BHESC-OVAL-MB |
| Square Escutcheon | BHESC-SQUARE-MB |

Fixing Kits

| | |
|----------------------------|----------|
| Secret Fixing Screw | 9F082 |
| 2 Pillar Single Fix (SI) | DAFK2PSI |
| 3 Pillar Single Fix (SI) | DAFK3PSI |
| 2 Pillar Back to Back (BB) | DAFK2PBB |
| 3 Pillar Back to Back (BB) | DAFK3PBB |
| Threaded Bar 120mm | DATB120 |
| Pillar Ring 30mm* | DHBHPR |
| Maintenance Kit | 9B045 |

*not required on Offset or Flat Bar Handles

Offset

Lengths: 400, 600, 800, 1000 and 1200 (two fix)

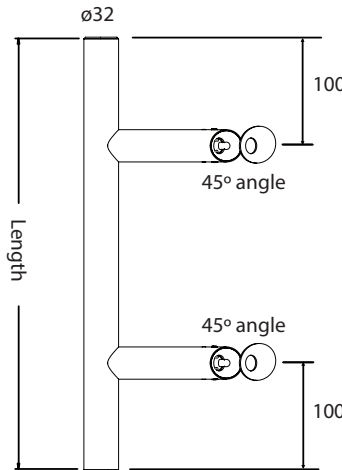

Inline

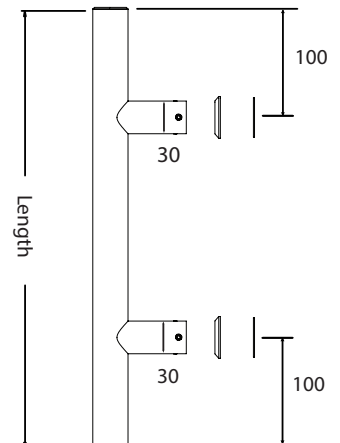

Lengths: 1400, 1600 and 1800 (three fix)

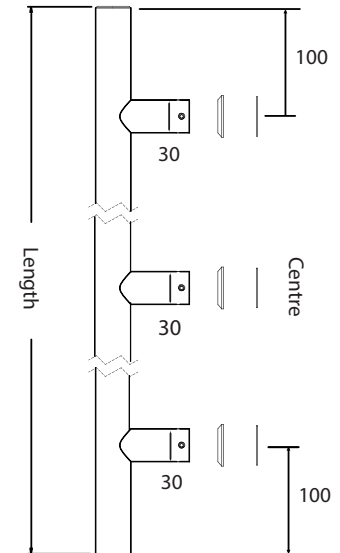
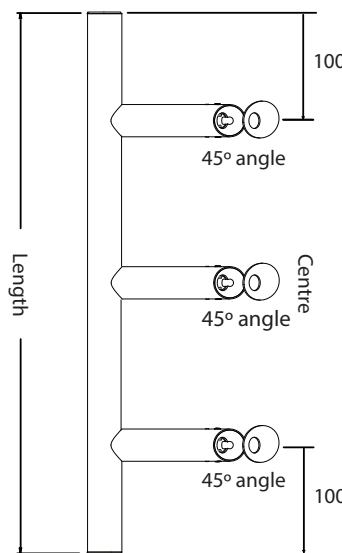

Fixing Kits

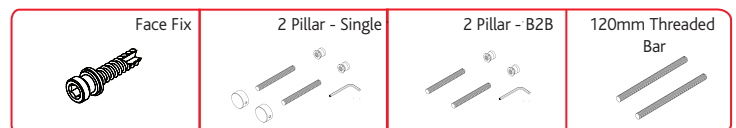

All dimensions are in mm and are nominal.
ERA reserves the right to change specification without notice.
It is the responsibility of the door manufacturer to ensure that the finished product meets any required safety and performance specification.

316 Stainless Steel Round Bar Handles

Technical Information

Performance

Salt spray tested to 2000 hours (BS EN1670: Grade 5)

Operation

Load tested to 1500N

Material Specification

Body: Stainless Steel 316 | Finish: Brushed Steel, Matte Black

Back to Back = 316 external / 304 internal

Maintenance

To maintain your stainless steel product in best condition, we recommend routine cleaning once a month. All exposed stainless steel surfaces should be wiped over with a clean cloth and warm water with a mild detergent on a frequent and routine basis. Cleaning should always be immediately followed by rinsing in clean hot water and the surface then wiped completely with a dry towel. For more stubborn dirt or stains use mild, non-scratching abrasive powders such as typical household cleaners. These can be used with bristle brushes, sponges or non-abrasive scourers. For more aggressive cleaning a small amount of vinegar can be added to the powder. Carbon steel brushes and steel wool should be avoided as they may leave particles embedded in the surface, which can lead to rusting.

Oval Escutcheon

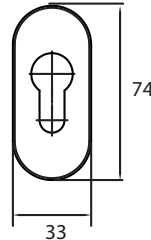

Square Escutcheon

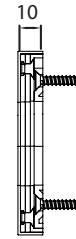
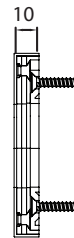
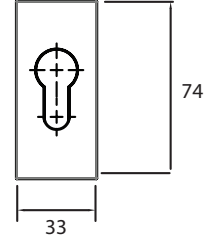

Bow

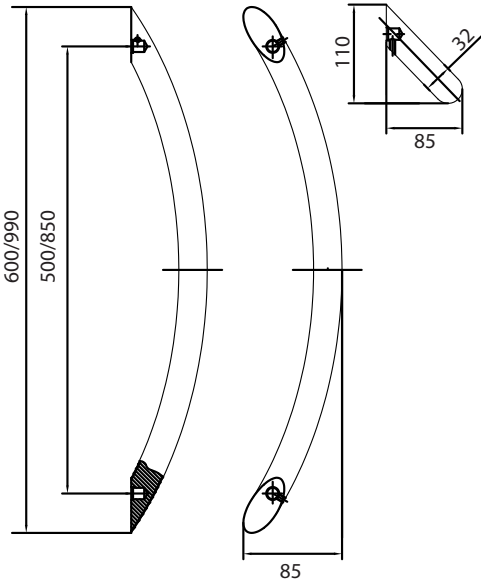

V Handle

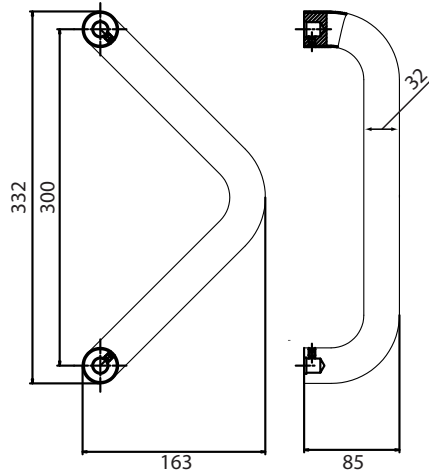

D Handle

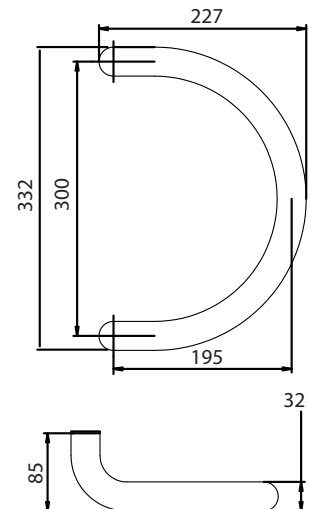

*V Handle and D Handle include pillar rings

Centre Knob

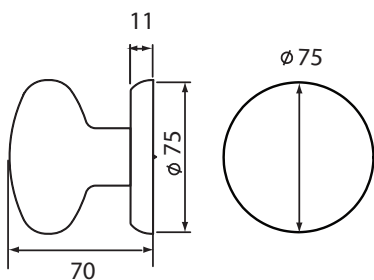

Fixing Kits

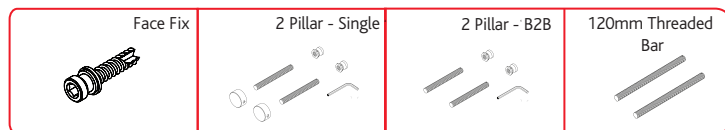

All dimensions are in mm and are nominal.
ERA reserves the right to change specification without notice.
It is the responsibility of the door manufacturer to ensure that the finished product meets any required safety and performance specification.