

Heavy Duty Type C Austenitic Friction Stay



Features

- High quality 304 Austenitic Stainless Steel for long life performance and enhanced corrosion resistance in accordance with BS EN 10088-2:2014
- Suitable for larger vents where extra weight carrying support is required from the friction stays
- Durable and reliable design
- Rigorously tested in accordance with BS EN 13126-6:2008 and BS 6375-1:2009 to ensure maximum carrying weights in maximum size windows meet the criteria for lasting safe performance of the stay
- Asymmetrical geometry of arms improves engagement
- Adjustable grub screw to control friction
- Available in Side Hung (10" - 18")
- 23mm wider track to support the extra carrying weights up to 155kg on 28" top hung hinges
- 16.5mm stack height
- PAS 024 security performance can be obtained in conjunction with a hingeuard in a compliant window system
- The hingeuard is designed to only engage when the window is under attack and prevents disengagement by supporting the friction hinge
- Window restriction can be achieved using a separate restrictor



Hingeuard Elite



Restrictor Stay

Technical Information

Corrosion resistance

Meets the requirements of BS EN 1670:2007 Grade 5 (480 hours)

Performance

Tested to 25,000 cycles of opening in accordance with BS EN 13126-1:2009 - par. 7.7.1

Material Specification

Bars, Arms and Rivets:	Stainless Steel BS EN 10088-2:2005 Austenitic (304)
Slider:	Polyamide and 304 Stainless Steel
Friction Cam:	Zinc to BS EN 1774:1998

Heavy Duty Type C Austenitic Friction Stay

Ordering Details

Heavy Duty, C Type, Side Hung 16.5mm Stack

Size (mm)	Nom Inch	Approx. Opening Angle	Max Width (mm)	Max Height (mm)	Max Sash Weight (kg)	Box Quantity (pairs)	Box Weight (kg)	Part No.
263mm	10"	82°	550	1600	36	6	3.8	G0814700001
313mm	12"	85°	600	1600	38	6	3.8	G0814800001
365mm	14"	87°	650	1600	40	6	3.8	G0814900001
414mm	16"	87°	700	1600	42	6	5.4	G0815100001
463mm	18"	87°	750	1600	45	6	6	G0815200001

Dimensions

Size (mm)	Nom Inch	Dim A	Dim B	Dim C	Dim E	Dim F	Dim G	Dim N	Dim P
263mm	10"	35	49	69	200.5	213	35.5	213.5	254
313mm	12"	35	49	69	225.5	238	35.5	252.5	304.5
365mm	14"	35	49	100	256	268.5	35.5	302	357
414mm	16"	35	49	100	277	289.5	35.5	339.5	406.5
463mm	18"	35	49	100	290	302.5	35.5	350	455.5

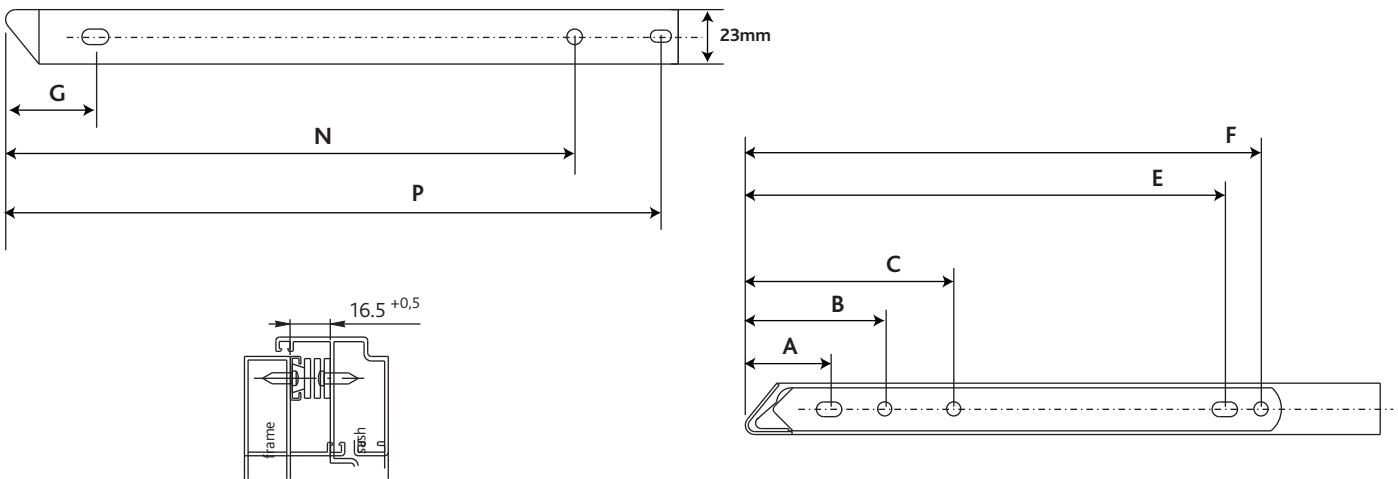

Maintenance

All moving parts should be lightly lubricated using a light non-acidic mineral oil (e.g. "3 in 1") twice per year and the surface cleaned with a soft damp cloth. The product may need to be adjusted and fixings tightened to ensure a satisfactory operation.

All dimensions are in mm.
ERA reserves the right to change specification without notice. It is the responsibility of the window manufacturer to ensure that the finished product meets any required safety and performance specification