

### British Standard 3 Star Anti Snap Euro Profile Cylinder



TS007-1:2014  
+A2:2018

## Features

- High performance euro profile locking cylinder guaranteed for ease of application and long term trouble free performance
- Designed with 6 pin 'bumping' resistance security, the anti pick, anti plug and anti drill features means the cylinder offers excellent resistance to forced entry
- If attacked, a security pin automatically triggers blocking the cylinder cam preventing unlawful entry. The cylinder can still be operated from the inside with a key
- Meets the requirements of PAS 24 as part of a compliant doorset
- Approved by Sold Secure Diamond
- Independently tested to meet the latest British Standards BS EN 1303:2015 for security and awarded a BS Kitemark
- Dual colour cylinder with brass keyhole
- 4 trap pins for enhanced pick resistance
- 12 hardened pins for drill resistance
- 80,000 differs
- Available in Single, Double, Thumbturn and Keyed Alike options
- Each cylinder is supplied with 3 keys



### Classification

The Fortress 3 Star cylinder has been approved to BS EN 1303:2015 and carries the following classification:

Category	1	2	3	4	5	6	7	8
Classification	1	6	0	0	0	C	6	2

### Packaging

**Fortress 3 Star Cylinder**  
1 cylinder per box, 10 per outer box

### British Standard 3 Star Anti Snap Euro Profile Cylinder

#### Ordering Details

##### Single

Dimensions			Finish	Part No.
A	B	C		
37.5	10	47.5	Dual	DCY3SFORES3510DCSK
41.5	10	51.5	Dual	DCY3SFORES4010DCSK
45	10	55	Dual	DCY3SFORES4510DCSK
50	10	60	Dual	DCY3SFORES5010DCSK
55	10	65	Dual	DCY3SFORES5510DCSK

##### Double

Dimensions			Finish	Part No.
A	B	C		
37.5	37.5	75	Dual	DCY3SFORE3535DCSK
37.5	37.5	75	Dual	DCY3SFORE3535DCTP2K
37.5	41.5	79	Dual	DCY3SFORE3540DCSK
37.5	45	82.5	Dual	DCY3SFORE3545DCSK
41.5	41.5	83	Dual	DCY3SFORE4040DCSK
41.5	41.5	83	Dual	DCY3SFORE4040DCTP2K
41.5	45	86.5	Dual	DCY3SFORE4045DCSK
41.5	45	86.5	Dual	DCY3SFORE4045DCTP2K
41.5	50	91.5	Dual	DCY3SFORE4050DCSK
41.5	55	96.5	Dual	DCY3SFORE4055DCSK
41.5	55	96.5	Dual	DCY3SFORE4055DCTP2K
41.5	60	101.5	Dual	DCY3SFORE4060DCSK
45	45	90	Dual	DCY3SFORE4545DCSK
45	45	90	Dual	DCY3SFORE4545DCTP2K
45	50	95	Dual	DCY3SFORE4550DCSK
45	50	95	Dual	DCY3SFORE4550DCTP2K
45	55	100	Dual	DCY3SFORE4555DCSK
45	55	100	Dual	DCY3SFORE4555DCTP2K
50	50	100	Dual	DCY3SFORE5050DCSK
50	50	100	Dual	DCY3SFORE5050DCTP2K

##### Double Thumbturn

Dimensions			Finish	Part No.
A	B	C		
37.5	37.5	75	Dual	DCY3SFORET3535DCSK
37.5	37.5	75	Dual	DCY3SFORET3535DCTP2K
37.5	41.5	79	Dual	DCY3SFORET3540DCSK
37.5	45	82.5	Dual	DCY3SFORET3545DCSK
41.5	41.5	83	Dual	DCY3SFORET4040DCSK
41.5	45	86.5	Dual	DCY3SFORET4045DCSK
41.5	50	91.5	Dual	DCY3SFORET4050DCSK
41.5	55	96.5	Dual	DCY3SFORET4055DCSK
45	45	90	Dual	DCY3SFORET4545DCSK
45	45	90	Dual	DCY3SFORET4545DCTP2K
45	50	95	Dual	DCY3SFORET4550DCSK
45	50	95	Dual	DCY3SFORET4550DCTP2K
50	45	95	Dual	DCY3SFORET5045DCSK
50	50	100	Dual	DCY3SFORET5050DCSK
50	50	100	Dual	DCY3SFORET5050DCTP2K
55	45	100	Dual	DCY3SFORET5545DCSK

##### Key Blank

BS 3* Fortress Cylinder Key Blank	BS-FOR-KEYBLANK-K
-----------------------------------	-------------------

Further sizes may be available - please contact the sales office for further information.  
Retail Boxed versions available on certain products.

Fortress 3 Star BS Single Euro Profile Cylinder

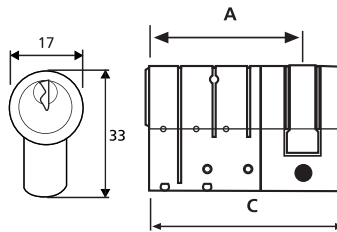

Fortress 3 Star BS Double Euro Profile Cylinder

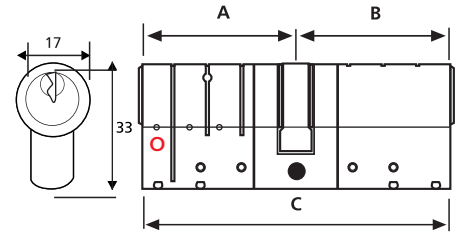

**IMPORTANT:** on all double cylinders where the dimensions are equal both sides of the cylinder e.g. 37.5/37.5, 45/45, 50/50 etc, the security protection is only on the external (O) side of the cylinder. You must ensure the cylinder is installed in the correct orientation, so the external side of the cylinder is visible from the outside of the door. This is denoted by an O marked on the cylinder itself.

Fortress 3 Star BS Double Euro Profile Thumbturn Cylinder

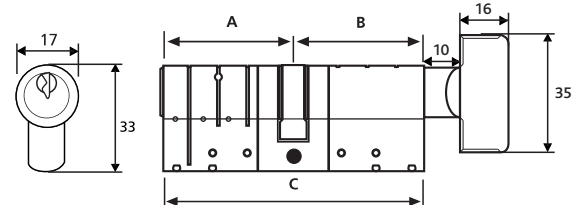

All dimensions are in mm and are nominal.  
ERA reserves the right to change specification without notice  
It is the responsibility of the door manufacturer to ensure that the finished product meets any required safety and performance specification.

#### Maintenance

Wipe the surface periodically with a soft cloth to remove excess grease or moisture.

#### Technical Information

##### Corrosion resistance

Meets the requirements of BS EN 1670 Grade 3

##### Operation

Endurance tested in excess of 100,000 cycles

##### Performance

Independently tested to meet the requirements of BS EN 1303:2015 and accredited to TS007 3\*. BSI Kitemark License No. 553031. Designed to meet the requirements of PAS 24 in a compliant door set.

Fire testes in accordance with EN1634-1 for 30 minutes and 60 minutes.

#### Material Specification

Cylinder:	Brass
Cam:	Sintered Steel
Pins:	2 hardened pins, anti bump anti pick and anti-drill
Key:	Nickel plated brass
Screw:	M5 x 45mm and M5 x 70mm nickel plated screws
Finish:	Satin nickel plated brass with brass keyhole